



2021 Skate Houston – Safety Plan B

Sept 3 – 6, 2021

Sugar Land Ice & Sports Center

Hosted by:

Texas Gulf Coast FSC

Hello Skate Houston attendees,

The Texas Gulf Coast FSC welcomes you to our annual Skate Houston competition! The event is scheduled to take place Sept 3<sup>rd</sup> to Sept 6<sup>th</sup>, 2021. It will be held at the clubs home rink, Sugar Land Ice & Sports Center, located at 16225 Lexington Blvd, Sugar Land, TX 77479.

The event is sanctioned by US Figure Skating, and as such will be complying with all rink, club, local and US Figure Skating regulations.

The following sections will outline the health and safety plan for the event, with specific instructions for all attendees. The guidelines are designed to keep everyone safe in order to hold a successful event. Failure to follow these guidelines can result in removal from the facilities and withdrawal of the athlete from the event(s). All questions or concerns should be directed to the contacts below. We look forward to having a safe and enjoyable event.

Competition Chair: David Rogers – [Competitions@TexasGulfCoastFSC.org](mailto:Competitions@TexasGulfCoastFSC.org)

Asst Competition Chair: Janelle Heallen – [Competitions@TexasGulfCoastFSC.org](mailto:Competitions@TexasGulfCoastFSC.org)

Chief Referee – Nancy Iida

# Overall Event Guidelines

- All Athlete waivers in EMS must be current and signed before participation in any events.
- Masks must be worn for all attendees at the time of the event. This policy is strictly regulated by US Figure Skating and the policy can be viewed [here](#).
- General registration for athletes, chaperones and coaches will be located in front of the Pro Shop window between the Event check in table (Rink A lobby) and Rink B lobby.
- Athletes 12 and under are allowed 1 chaperone to assist them.
- The chaperone must be over 18 years of age and an immediate family member as defined in the [U.S. Figure Skating's Safe Sport Handbook](#).
- Chaperones and Spectators will be allowed to watch the event per the guidelines in this document.
- Skate Orders and results will be posted online. A link will be provided later.
- Locker rooms will not be available for changing. Come dressed and ready to skate. Changing and make up application will not be allowed in the restrooms.
- A mandatory zoom orientation meeting will be held for participants before the event. A meeting notice will be sent at a later time.
- A detailed schedule will be provided and all documents will be posted on the [TexasGulfCoastFSC.Org](#) website.
- Each section in this document will outline the guidelines for participants. Adherences to the guidelines are mandatory.
- If you have a fever or feel ill, you are asked to stay home and not attend the event.

# Athlete & Chaperone Guidelines

Athlete & Chaperone Flow

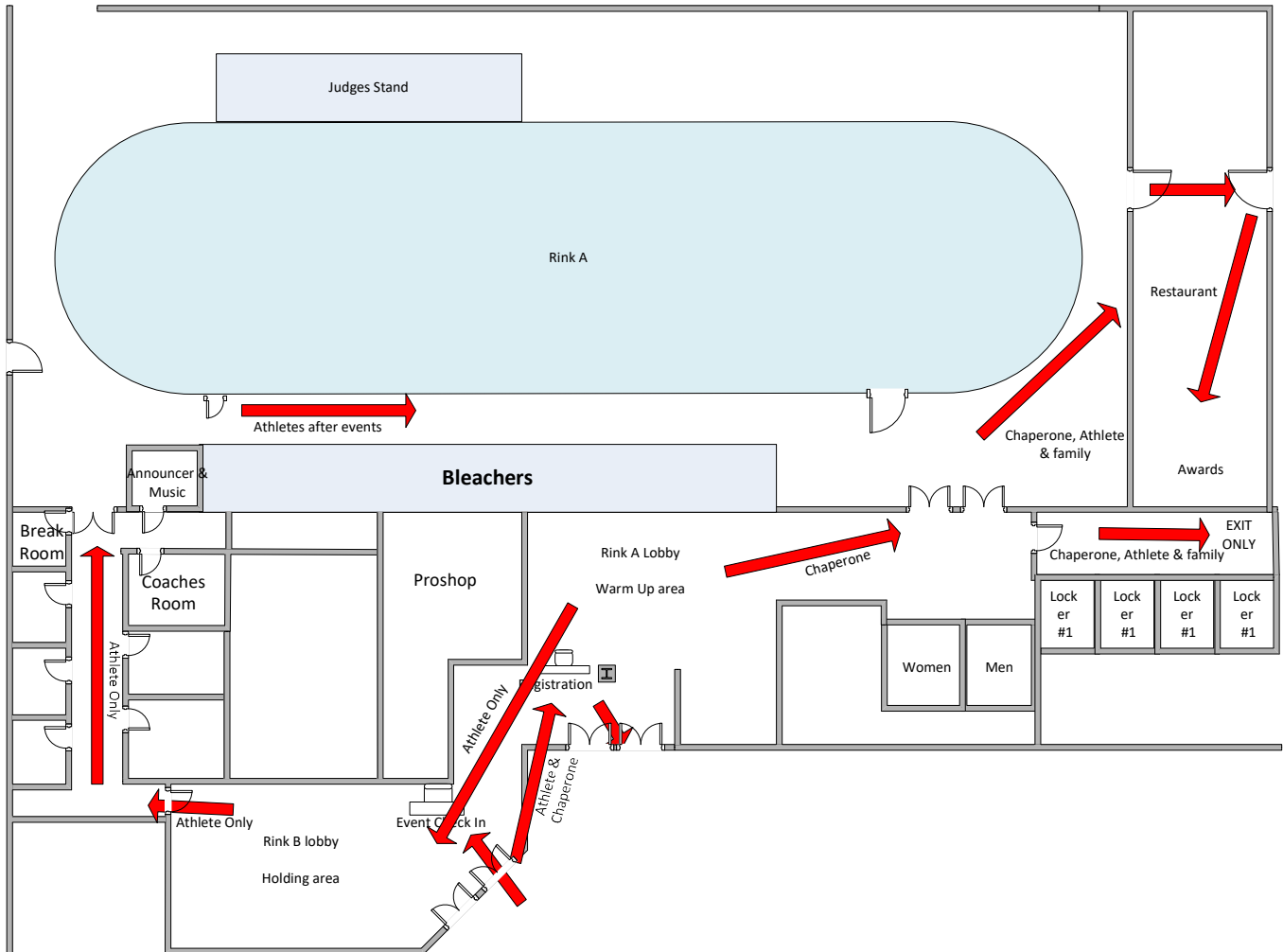

- Athletes and chaperones will follow the mask policy under the general guidelines section in this document.
- Athletes are able to register any time, before their event check-in time, at the registration table to receive their credentials. All outstanding debt needs to be paid before credentials are issued.
- Athletes and Chaperones will check in at the Event Check-In table only at their designated time.
- Athletes must arrive dressed and ready to skate. There will not be an area to change or apply make-up. Skates should be put on in the Rink A lobby. Rink B lobby will not allow time to put skates on.
- If a chaperone is assisting with putting skates on, the chaperone will take the skate bag with them into the arena. If the skater does not have a chaperone, the skater will take their skate bag to Rink B holding.
- At their designated time, athletes will proceed to the rink side area to take the ice for their warmup.

- All skaters that have skate bags with them will bring their skate bag to rink side.
- Once the skater has finished competing, they will exit down the bleachers to meet their families and can watch the remainder of their event.
- Once their event is over, skaters, chaperones and families are to exit the building through the back hallway or the restaurant.
- Athletes and Chaperones must wait outside until their online results are live.
- Athletes and Chaperones will proceed to the awards area for their medal if placement has earned a medal. The awards area will be located either in the restaurant interior or on the restaurant patio. Once the medal is awarded, athletes and chaperones are to leave the building.

# Spectator Flow

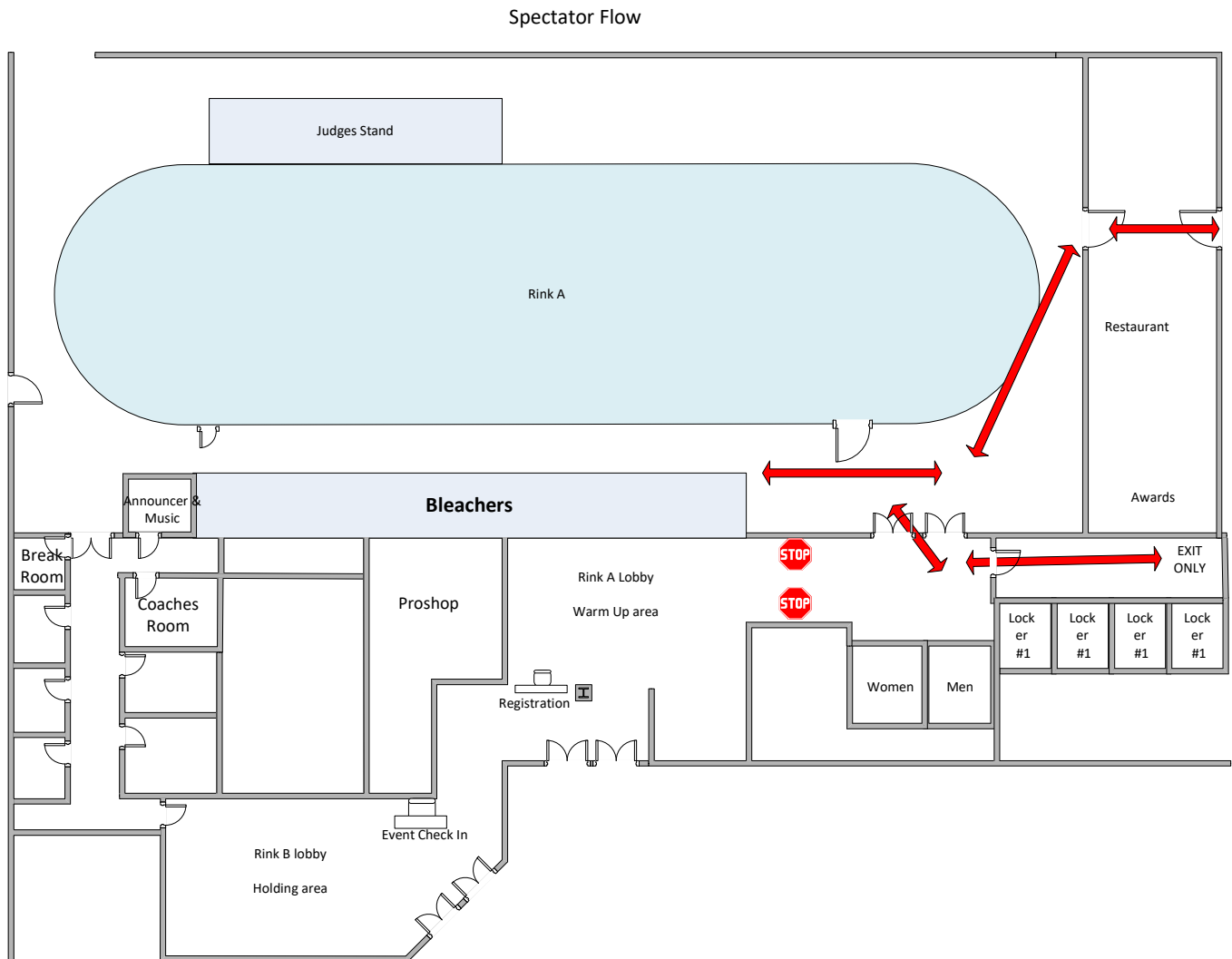

- Spectators will follow the mask policy under the general guidelines section in this document.
- Spectators will enter the facility through the restaurant at the front of the building.
- Spectators will only be allowed to enter during their athletes designated event time.
- Spectators will proceed to the bleachers and sit while maintaining CDC social distancing guidelines.
- After the athletes' event, spectators will need to leave the building through the restaurant or locker room exit.
- Spectators must remain outside until their athletes' event results are live.
- Spectators can proceed to the awards area only after the results are posted. The awards area will be located either in the restaurant interior or on the restaurant patio.
- Once their athlete is awarded, they must leave the building.

# Coaches Flow

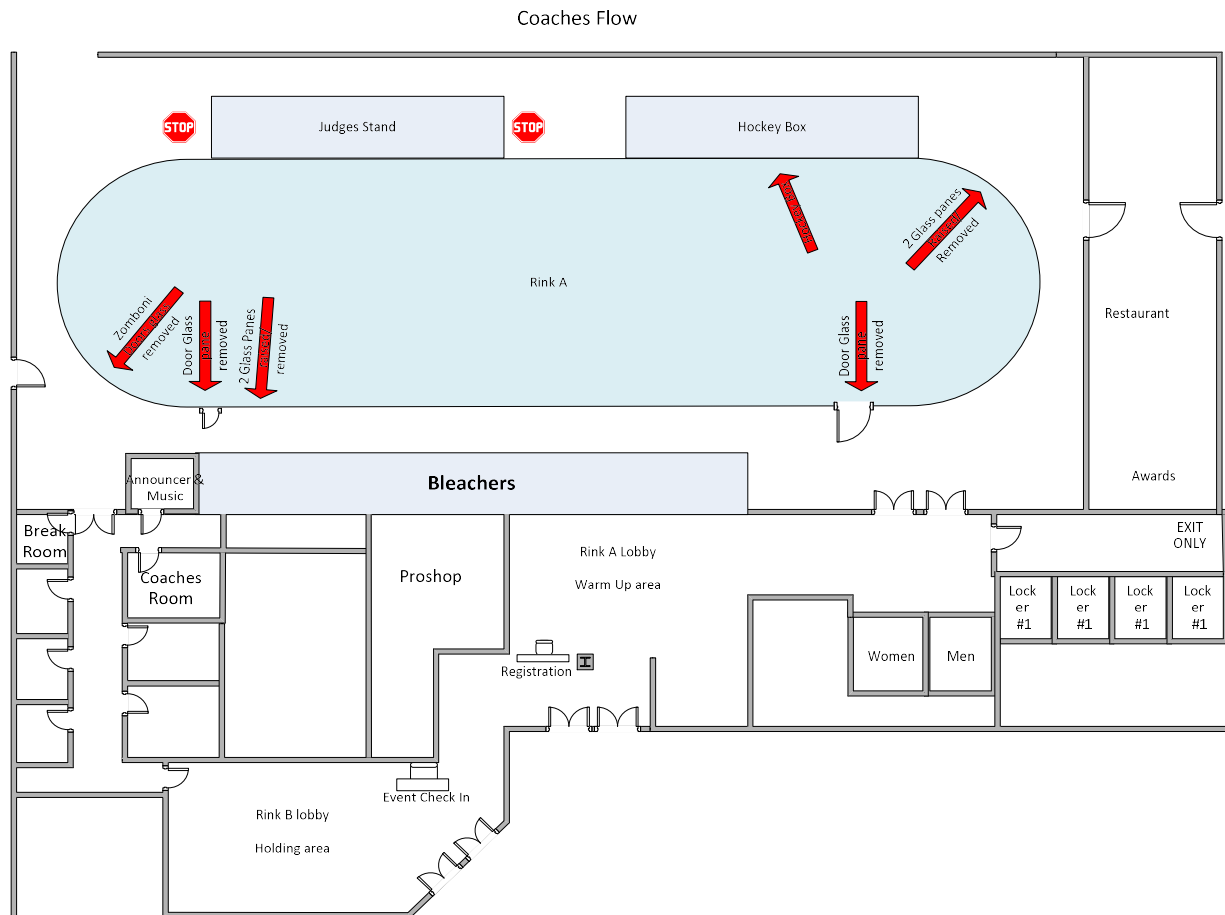

- Coaches will follow the mask policy under the general guidelines section in this document.
- Coaches will pick up credentials at Registration.
- Credentials are to be worn at all times within the facility. A coach without credentials will be asked to leave the facility.
- Coaches should not stay in the rink between events unless they have another athlete in the group.
- Two (2) coaches will be allowed per athlete in the building.
- Coaches may utilize the hockey box, both doors and any raised windows during practice ice. They may not utilize any area staged for officials that may contain equipment. They may also utilize raised windows during events.
- Coaches are not allowed in the break room or coaches room for any reason during the events.

# Practice Ice Flow

Practice Ice Flow – Regular (Morning & Evening)

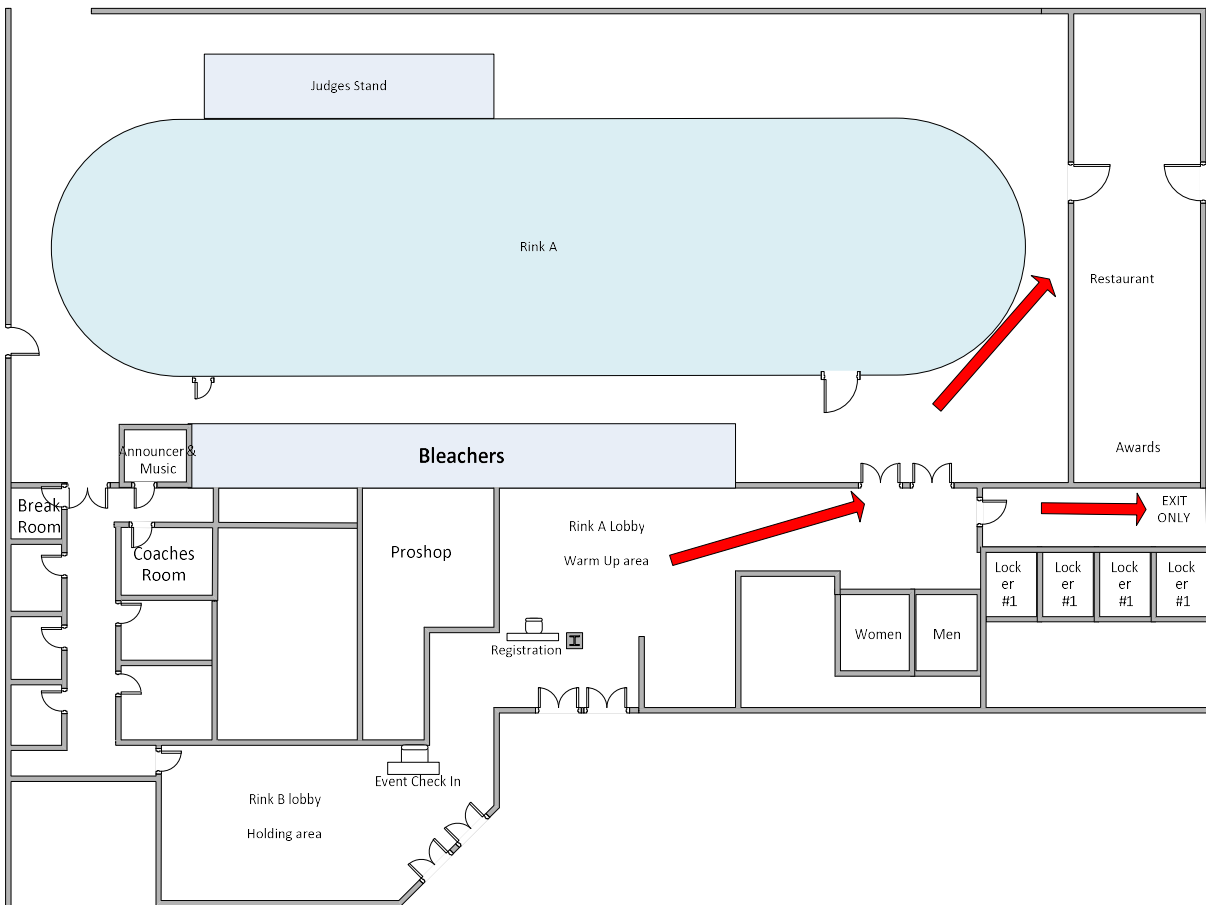

- Athletes, Coaches and chaperones will follow the mask policy under the general guidelines section in this document.
- Locker rooms will not be available. Athletes are encouraged to come in with skates and guards on and dressed ready to skate.
- Due to the number of athletes on each practice ice session, indoor warmup will not be available so warmup ahead of time is encouraged.
- Music will not be played at practice ice.
- Ice monitors will direct the skaters to the door they will use to enter/exit the ice.
- All coaches, athletes and chaperones will be required to exit the rink and leave the building promptly once the session is complete, unless you are on the next session or an event is immediately following the session.



# Officials Flow

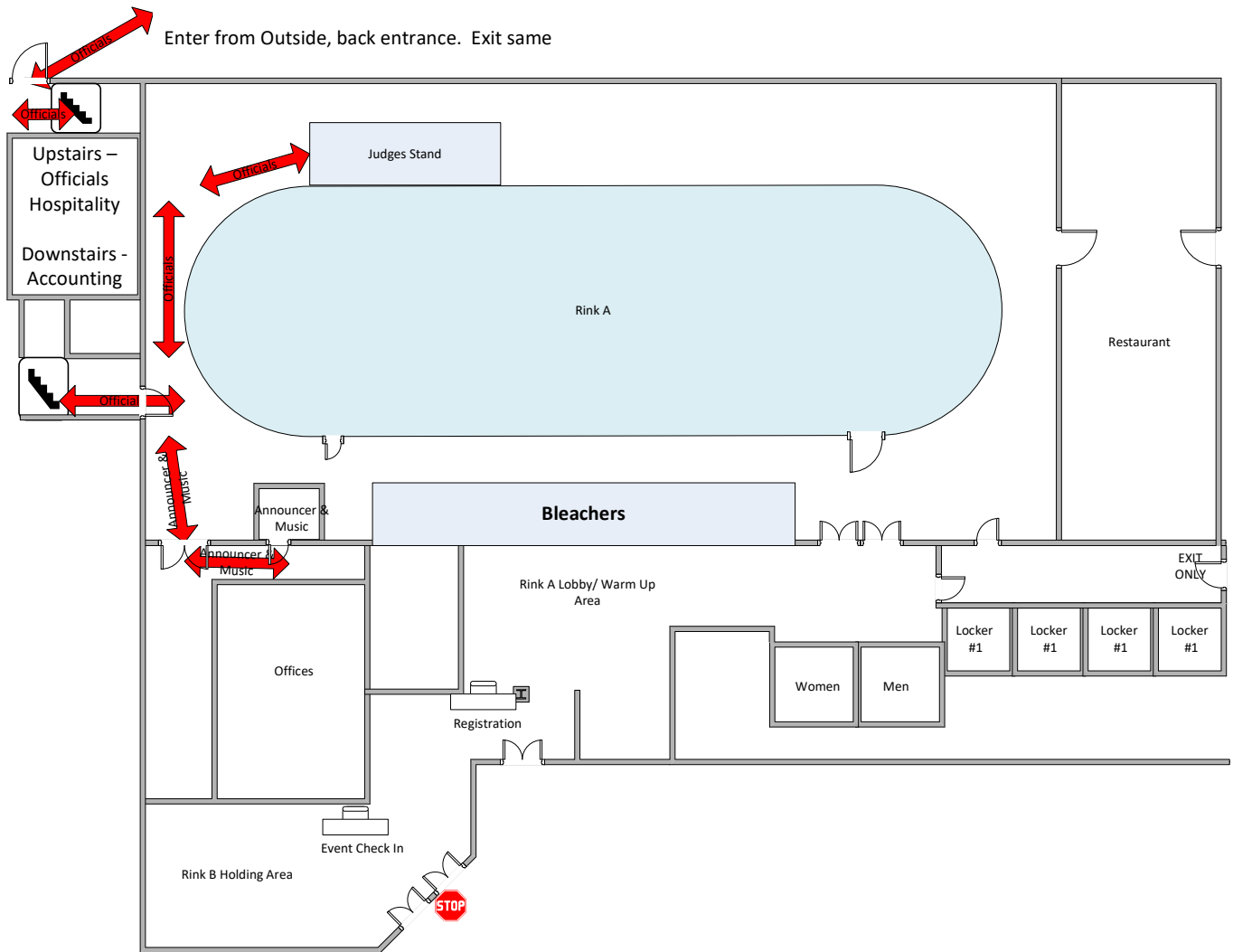

- Officials will follow the mask policy under the general guidelines section in this document.
- Officials will enter from the back side, rear entrance of the building. This entrance is an OFFICIALS ONLY entrance and exit.
- Hospitality will be upstairs and accounting will be downstairs.
- Hospitality will be setup to follow social distancing guidelines.
- Meals and snacks will be individually wrapped and consumed in hospitality area only.
- Regular sanitation will be performed in the hospitality area and judging platforms. Sanitization supplies will be readily available as needed.

## Disinfecting Process

- Holding areas to be regularly disinfected
- Spectator areas will be disinfected at each ice make.
- Practice ice areas will be disinfected after practice ice sessions are complete.
- Official's staging areas will be disinfected at each ice make.

## Covid Considerations

- Must not be exposed to known positive covid-19 individuals without proper droplet plus universal precautions (gloves, gown, mask, shield).
- Must not have a cluster of the CDC signs/symptoms of Covid-19.
- Temperature not to exceed 100.4 degrees.
- Any individuals unable to pass temperature screen to not be permitted into the event.
- In the event a temperature screen is failed:
  - ATHLETES & COACHES: will be informed to wait outside for an LOC. The screener will put in a radio call for an LOC to evaluate Athletes and Coaches. The LOC will make the final call and they will notify Registration & Debra Dryburgh (Accounting) the Athlete or Coach has been withdrawn.
  - VOLUNTEERS / CHAPERONES: Will be informed to leave the facility. LOC re-check is NOT required. Screeners will notify Registration if a Volunteer has been denied access so they can begin to find a replacement.
  - OFFICIALS: will be informed to wait outside for an LOC. The screener will put in a radio call for LOC to evaluate. The LOC will make the final call and notify Nancy Iida (Chief Referee) the Official has been withdrawn.
- Easy access/ Availability of hand sanitizer will be available throughout the facility.